

FOR SALE

**14 BRIDGE STREET,
STRANRAER, DG9 7HY**



Occupying a prime trading location within the heart of Stranraer, an opportunity arises to acquire a spacious retail unit. The property benefits from a well-decorated front retail space, office, storage rooms, and WC. It has previously been partitioned to provide two smaller units.

Please note this sale is for the premises only.

PRICE: Offers over £55,000 are invited



Property Agents

Free pre – sale valuation

High profile town centre display

Residential / Commercial
Letting Service

Proven Sales record

Introducers for
Independent Financial
& Mortgage Advice

Charlotte Street
Stranraer
DG9 7ED

Tel: 01776 706147
Fax: 01776 706890

www.swpc.co.uk



DESCRIPTION:

The property occupies an excellent trading location within the heart of the town centre and offers multiple uses for the next owner.

The property benefits from bright, well-decorated retail space, office, storerooms, and WC.

ENTRY: Negotiable

VIEWING: By appt with **S.W.P.C**

DETAILS PREPARED: 13/10/2023

RATEABLE VALUE: £6850

SERVICES:

Mains electricity, water, and drainage.

OFFERS:

All offers for the above property should be made in writing to

South West Property Centre Ltd,
Charlotte Street, Stranraer, DG9 7ED.
Telephone (01776) 706147 Fax: (01776) 706890
www.swpc.co.uk

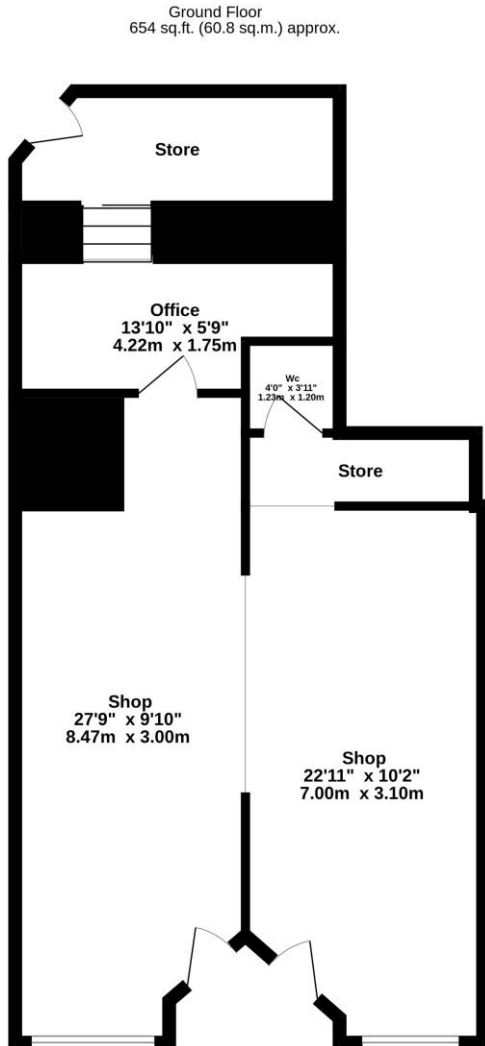

TOTAL FLOOR AREA : 654 sq.ft. (60.8 sq.m.) approx.
Measurements are approximate. Not to scale. Illustrative purposes only
Made with Metropix ©2023

Although prepared with care and believed to be correct, these particulars are not guaranteed and will not form part of any contract. Purchasers should satisfy themselves as to all points. Where dimensions are quoted, they are approximate only. Heritable systems and appliances are untested and sold as seen and no warranty is given. Prospective purchasers should make their own investigations and enquiries.

The photographs used are for the purpose of illustration and may demonstrate only the surroundings. They are not, therefore, to be taken as an accurate indication of the extent of the property. Also, it should not be assumed that the photographs are taken from within the boundaries of the property, or show what is included in the sale. **Your home is at risk if you do not keep up repayments on a mortgage or other loan secured on it.**